



# Largest number of GREEN CERTIFIED Modular Interior Systems IN INDIA

All copyrights, trademarks, Intellectual property rights, patents reserved in name of IQUBX pvt ltd and its directors. Any copying of logo, images, designs, product designs without explicit written permission of the directors of IQUBX pvt ltd shall be a punishable offence. All the product designs are IPR protected



## Innovative Green Certified Modular Interior Systems

[www.iqubx.com](http://www.iqubx.com)

# A few of our **prestigious** clients

---

**AECOM**

**GAR**  
Creating tomorrow today

**Tech  
Mahindra**

**Seven Seas**  
LUXURY BANQUETING  
OUTDOOR CATERING

**CUSHMAN &  
WAKEFIELD**

**LARSEN & TOUBRO**

**DLF PROMENADE**

**EMAAR**

**Pavilions  
and  
Interiors**  
India private limited

**IIT Limited**

**WAVE  
One**

**Reliance  
Industries Limited**

**SIEMENS**

**Metro  
Railway,  
Kolkata**      **Kolkata  
Metro Rail  
Corporation**

**IIT, Delhi**

**DLF  
Mall of India**

**Fortis  
HOSPITAL**

**DMRC**

**MIT UNIVERSITY**  
ART, DESIGN & TECHNOLOGY

**avantika  
UNIVERSITY**

**bharti AXA**  
life insurance

**Kajaria**  
Sustainable Value Added

**O.P. Jindal Global University**  
A Private University Promoting Public Service

**artizen**

**VLCC**  
SHAPING YOUR CONFIDENCE

**Govt of Nepal**

**ASTA  
BERRY**

**TAKENAKA**

**ISA**  
Architects

**VYOM**  
Architects

**GOWRA  
VENTURES**

**Aijaz Hakim Architects**

**the essentia**  
BHIWADI

**GOLDFISH**  
ARODE PVT LTD

**translumina**  
therapeutics

**THE FITOUT.CO**

**Exports to Canada, Maldives, Nepal**

◀ Widest  
range of  
Green  
certified  
Modular  
Interior  
Systems ▶

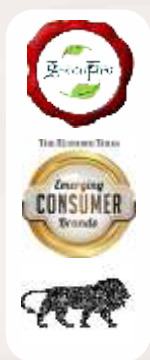

**MODULAR BAFFLE CEILINGS**

**CEILING TRAP DOORS**

**GLASS PARTITION SYSTEMS**

**DOOR AND DOOR FRAMES**

**DEMOUNTABLE PARTITION SYSTEMS  
PANELING SYSTEMS**

**DRY WALL CLADDING PARTITIONS FOR WET AREAS**

**WORK STATIONS LEG SYSTEMS**

**FLIPTOP BOX FOR WORKSTATIONS**

**MODULAR WORKSTATION PARTITIONS**

**ELECTRICAL TRUNKING SYSTEMS**

**FLOOR JUNCTION BOX**

**FLOOR BOX**

**FLOOR RACEWAYS**

**OPEN MODULAR FRAME STRUCTURE SYSTEM**

**CABLE TERMINATION RACK - DISTRIBUTION RACK**

**SKIRTING BOARD**

**CHAIR RAILS, CORNER GUARD, CARPET TRANSITION PROFILE**

innovative | quick to install | highly customizable

+91 9999001967, 8506074444

Largest number of GREEN CERTIFIED MODULAR INTERIOR SYSTEMS IN INDIA

Very innovative and green certified, IQUBX modular interior systems can help create offices ultrafast with minimum human labour and very economic cost. These systems can be easily modified, making such spaces very adaptable and flexible to cater to changing future requirements. We can provide custom modular solutions for your requirements as well.



www.iqubx.com

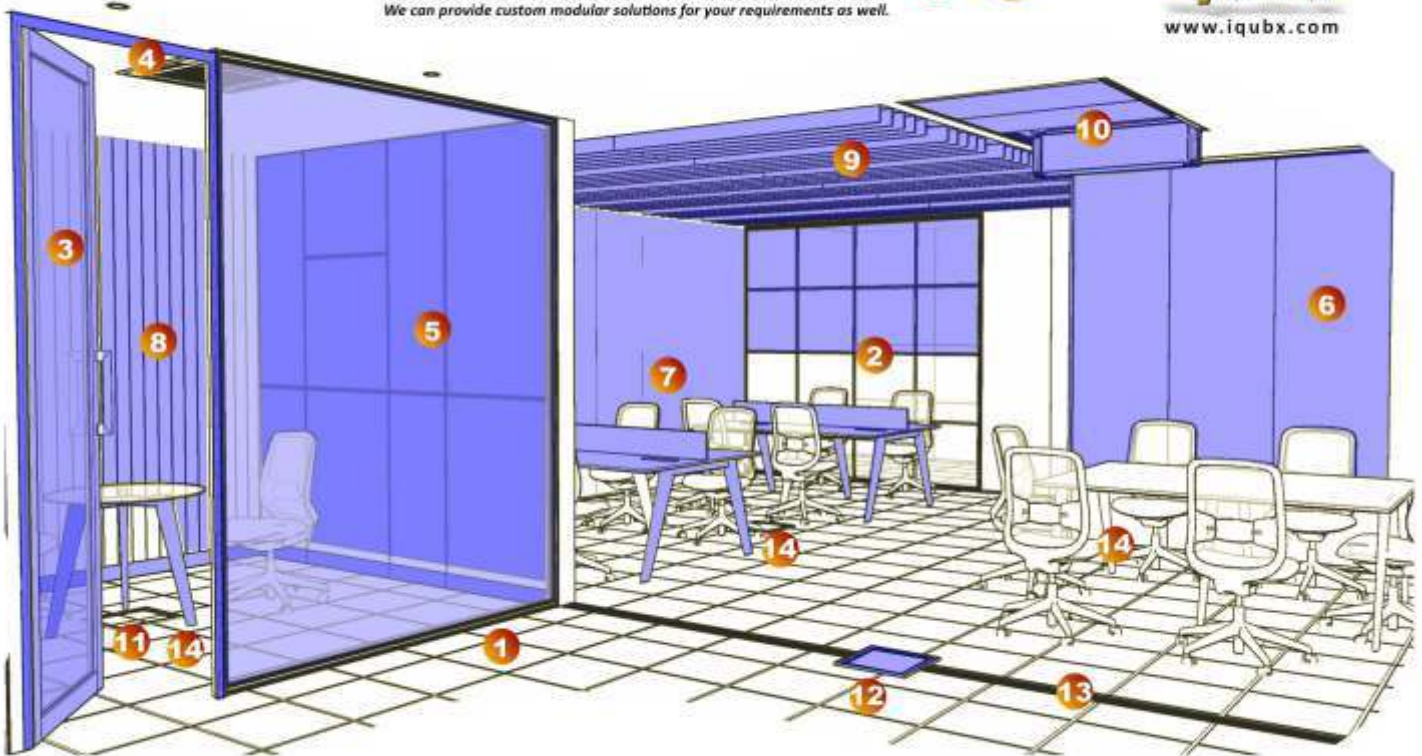

### IQUBX for COMMERCIAL OFFICE & CO-WORKING SPACES

- 1 Glass partition 2 Grid glass partition 3 Glass stile door 4 Modular Door frame 5 Demountable wall partition 6 Dry wall stone / tile / paint partition
- 7 Wall paneling 8 Aluminium wall paneling 9 Baffle ceiling 10 Ceiling trap door 11 Floor junction box 12 Floor box 13 Raceway 14 Modular table leg system

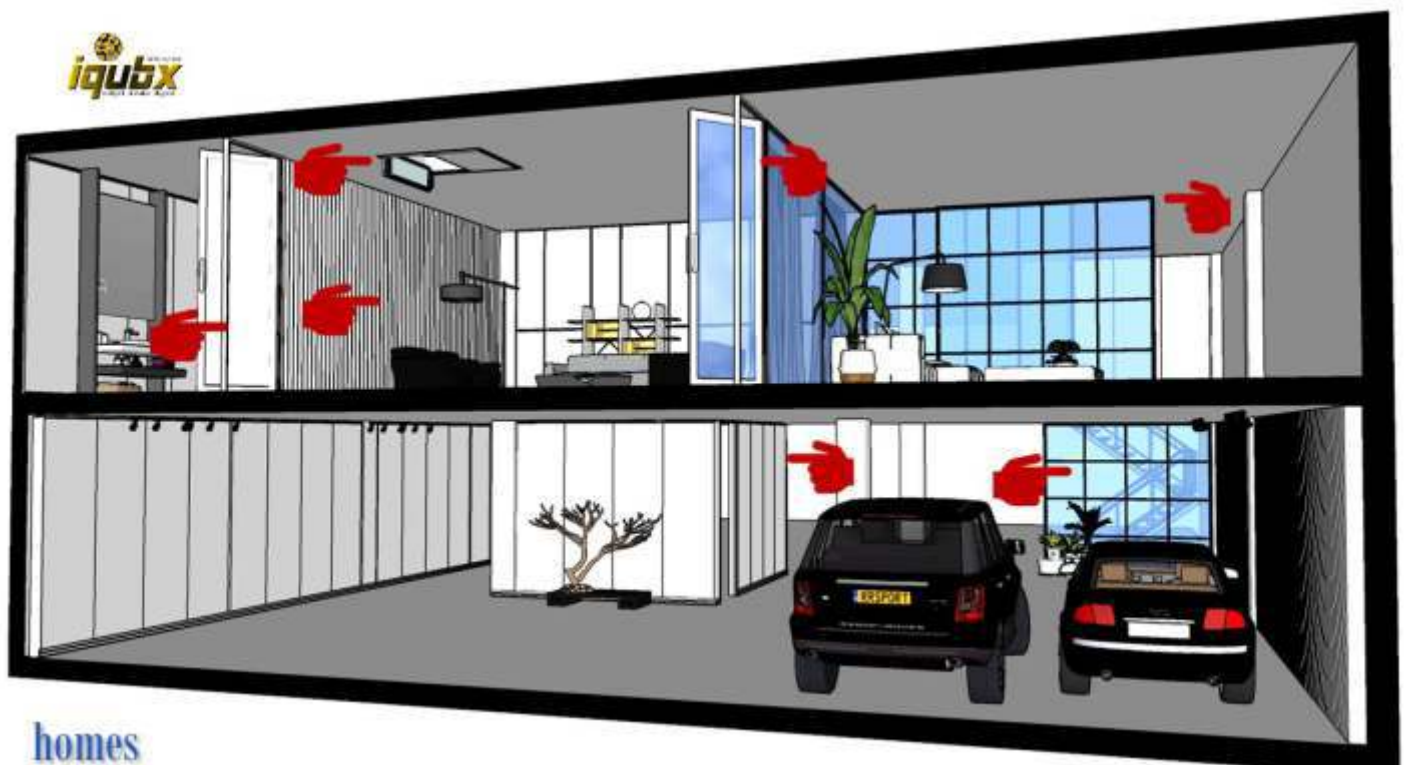

homes

# Applications

- Offices | Residences
- Hospitals | Institutes | Universities
- Retail | Hotels
- Smart Cities | Airports
- Railway & Metro Stations

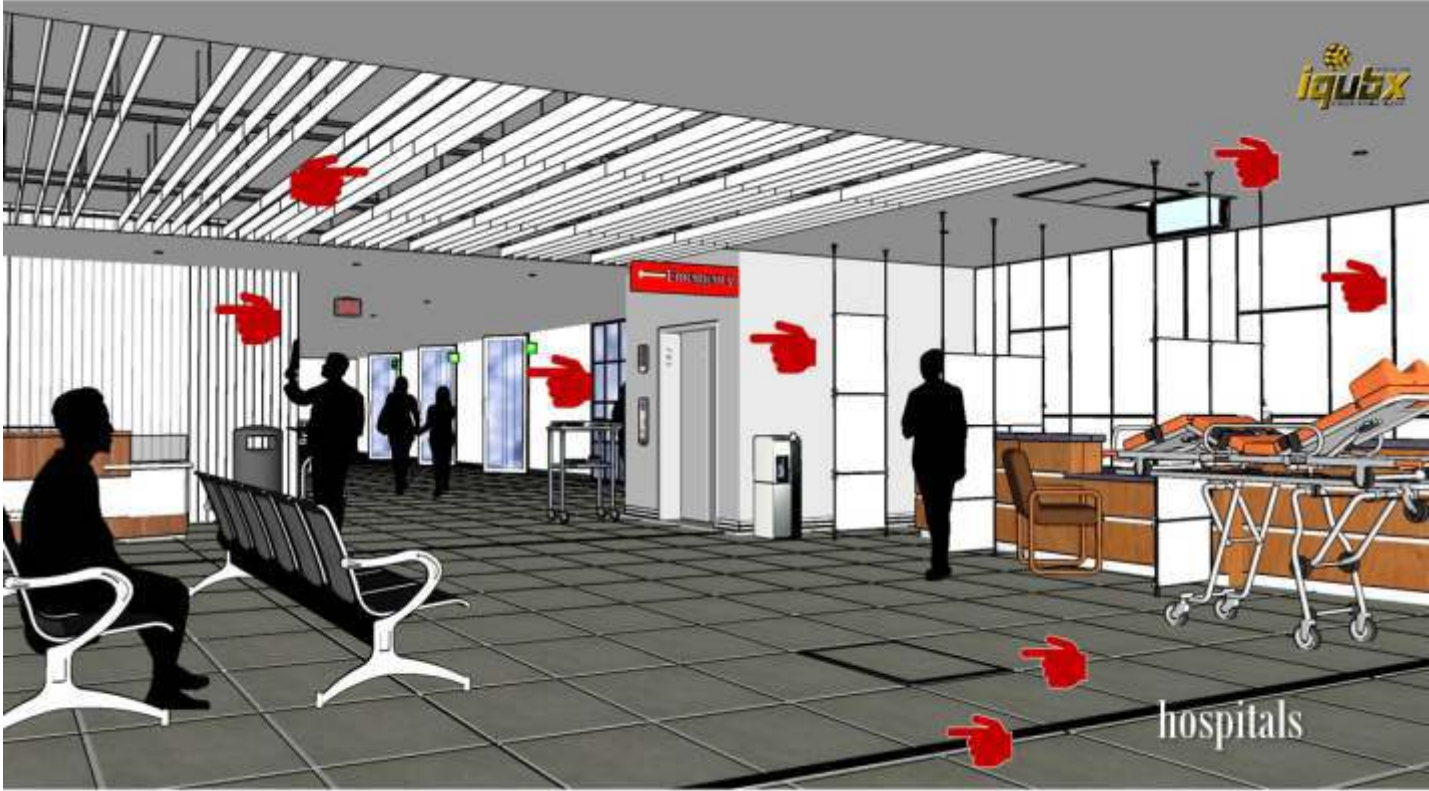

# Awards & Recognitions



**IQUBX selected amongst 20 north zone finalists**



A		B		C		D	
1. Quality of products	2. Reliability of products	3. Durability of products	4. Safety of products	5. Environmental friendliness	6. Innovation in products	7. Customer service	8. After-sales service
9. Price competitiveness	10. Market share	11. Brand value	12. Social responsibility	13. Employee satisfaction	14. Leadership in the industry	15. Financial performance	16. Overall reputation



## Features

“Our highly flexible, high performance, customizable & reusable green certified interior systems can bring down capital cost and time of creating interiors from many weeks to a few days, with minimum labour – at optimal prices and minimum carbon footprint. They can even be reconfigured to match with evolving future requirements and can easily be relocated, saving huge investments and giving freedom to users in their decision making”



Very Innovative, Unique and patent applied designs



Greenpro certified, made of recycled aluminum 6063 alloy T6 tempered



Sophisticated engineering



Very High performance



Made completely in India



BS 476 Part 6 Fire Propagation Class 0  
BS 476 Part 7 Surface Spread of Flames Class 1  
BS 6853:1999 .Smoke Emission. Pass  
BS 6853: 1999. Toxic Fume Emission. Pass,  
T6 6063 aluminium alloy is non-combustible, doesnt burn, melts with no gaseous release, has high thermal conductivity; powder coating on aluminium further enhances the fire resistant properties;

## Benefits



Ultra Fast instalation on site



Minimum manpower on site



Very Economic pricing



Highly Customizable as per your requirements



High level modularity - Modifiable even post-installation



Relocatable



Minimum Turn-around-time



Minimum components for better logistics and maintenance



Made in India ensures future availability of spare components



Contributes to Sustainable project requirements



New Custom solutions designed as per your requirements





“ *Be Agile | Be lean | Dream boundless* ”

These systems are innovative, integrated & intelligent - I cubed, and hence – **Iqubx**

**All systems are designed and manufactured in India, are design rights protected and have 3 patents applied**



“

**We have redefined “modularity” in interior systems space and brought a complete paradigm shift in our market space.**

**We deliver the promised value proposition because of our core structure and philosophy.**

”

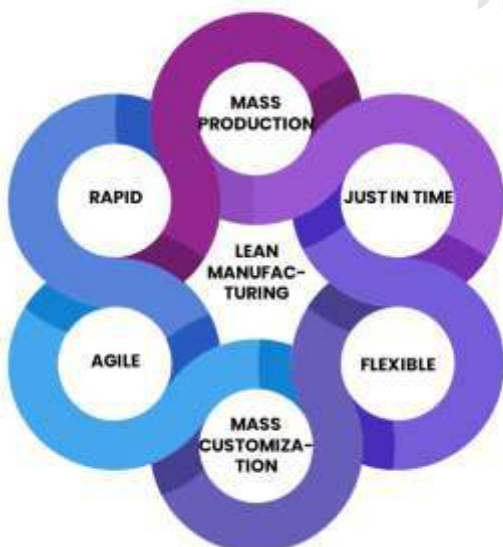

I QUBX is the designer & manufacturer of the **largest number of Green certified Modular Interior systems in India**. Certified by Indian Green Building Council, most of them are **the only products with green certification in India in their categories**.

Born as a DIPP registered startup in 2017, we are a company which has grown out of passion and is very **agile, lean and customer centric**, with no existential boundaries or rule book.

The organization was **founded by Mr Amit Garg, B.Arch, M. Arch** from prestigious School of Planning and Architecture, New Delhi, with more than 25 years of experience in domain of Architecture as well as Interiors.



## **MODULARity**

Lean & Agile  
Manufacturing  
Asset light organization

**All our systems are innovative, high performance and packed with features;** thus, providing a huge list of benefits for all stake holders – designers, contractors, investors, end users and Environment.

Our innovative systems like *glass & solid partitions, baffle ceilings, ceiling trap doors, workstation systems, doors and door frames, junction boxes and raceways and different paneling and cladding systems* are designed entirely in India and are being appreciated globally for their out-of-box approach. A few of them have even patent applied on them.

Core of innovation in these systems is that they **can be assembled with minimum number of components multifunctional components freely integratable with one-another, just like a LEGO toy.** We have opted for scalable manufacturing techniques and materials like **100% recycled aluminum** for its high manufacturability and endless recyclability. Our systems are designed to protect the environment by bringing down drastically the energy footprint of product development as well as each system installation. This makes our systems very economical & environmentally sustainable.

*The real innovation is however, using these systems to evolve other system solutions. For instance, the open rack modular rack system designed as import substitutes for Siemens' signaling equipment requirements was used to create a 80 feet X 25 feet light weight partition at Hyderabad airport. The same system is harnessed for creating our workstation leg systems and dry wall cladding room partition system as well.*

Our “**innovation**” (a word coined by Mr Amit Garg) or **entrepreneurial innovation**, and authentic work has enabled of our products to be on **page 1 rank 1 of Google organic search result pages.** This has made us discoverable all over India and the world, enabling professionals, brands and entrepreneurs to seek us out for our solutions.

**IQUBX is on a path to become a global brand**

*The **Baffle ceiling systems** include patent pending models with changeable finishes and integrated lighting; modular stackable model and a very cost-effective design where one can have any height as required. Our ceiling trap doors can be made to any size and are very safe & easy to install.*

*The high acoustic performance **glass partition systems** can have single or double glass pane in same frame. Demountable partitions are ultra-fast installing with removable and changeable panels to easily access embedded services like electric conduits.*

*Our **dry wall cladding room partitions** can create rooms and wet area overnight, while floor boxes and floor junction boxes can be made to any size and create beautiful interiors with floor finishes embedded in the lids.*

*The DIY kit like **modular leg systems for workstations and tables** can be completely reconfigured to create different sizes and layouts of workstations very easily and without any wastage – that too, right on site itself.*

design objectives	product features / design strategies	advantages
<p><b>Minimum wastage &amp; logistics</b></p> <p><b>Lower development cost &amp; fast product evolution to address customer needs</b></p> <p><b>Overall lesser impact on environment with ease of recyclability</b></p> <p><b>Highly engineered design at micro level to deliver a holistically simple products</b></p>	<p>Innovative and <b>unique patent designs</b></p> <p><b>Modular construction</b></p> <p><b>Minimum number of components</b>            Floor Junction box ( patent pending) has only 3 profiles            Ceiling Trap door has just 3 profiles            Skirting &amp; Chair rail has single profile with the waste section used as mounting cleat on which the skirting profile self- interlocks.</p> <p><b>Multipurpose use of same Components in different products &amp; multi use of same product system for different functionality</b>            Junction Box &amp; Ceiling Trap door – both are having same profile            Skirting &amp; Chair rail – are also having same profile            CTR, CDR, Server panel &amp; electrical panel – two different products but are having the same profile            Glazed partition, modular work station partition &amp; door frame – are also having same profile</p> <p>Avoiding connector parts through <b>innovative standardized joinery</b> like nuts &amp; bolts, screws across product lines</p> <p><b>Maximum homogeneity</b> of basic material – <b>100% recycled aluminium</b></p>	<p><b>Highly reusable</b> and High Scrap value</p> <p><b>minimum wastage and logistics</b></p> <p>long life cycle of product</p> <p><b>Very low maintenance - Robust,</b> strong, durable and non-corrosive</p> <p><b>minimum and fast assembly time,</b> ease of disassembly and repair, reduced human labor</p> <p>ergonomic comfort of end users &amp; <b>enhanced functionality</b></p> <p><b>Cost effective designs</b></p> <p>built in flexibility of <b>customization as per client requirements</b></p> <p>ideal for recyclability of pre-consumer as well post-consumer material – <b>meeting user organization sustainability goals</b></p>

Published April 2022



APPOINTING  
DISTRIBUTORS  
ALL OVER INDIA  
& OUTSIDE

IQUBX PVT LTD  
Plot No 22, khasra no 27/10,  
Industrial Area, Nangli Sakrawati,  
Near Campa Cola Factory,  
Najafgarh, New Delhi, 110043

[www.iqubx.com](http://www.iqubx.com)  
<https://www.facebook.com/iqubx/>  
<https://www.linkedin.com/company/iqubx/>  
<https://www.instagram.com/iqubx/>

### Modular Green Building Furniture & Interior Systems

Mktg +91 9999001967, 8506074444, 7065444402 | [info@iqubx.com](mailto:info@iqubx.com)

*The only certified Green Products in their categories in India*

We design customized solutions

#### Modular Aluminum Interior products

Glass Partition Systems - Single, Double Glazed, DGU Glass  
Demountable Wall Partition & Paneling Systems  
Doors and Door Frames  
Free standing office cabin partitions & booths  
Dry Cladding Readymade Room Partition Walls (Drywall - Stone & Tiles)  
Modular Baffle Ceiling Systems (PATENT applied)

#### Ceiling Trap Doors

Work Stations, Modular table Leg Systems, Modular Partitions, Popup Boxes  
Misc: Skirting Board, Chair Rail, carpet transition profile, corner guard

#### Modular Aluminum Electrical products

Floor Boxes, Floor Junction Boxes (PATENT applied), Raceways  
Floor Raceways Trunking Systems  
Cable Distribution & Termination - Open Frame Racks - 2 & 4 Poles, D Ring



certified by  
IGBC, CII

High performance & Functionality **Ultrafast installation** Minimum Human Labour  
**Highly customizable** Modifiable **Relocatable** Minimum components

distributor



view auth  
distributor  
list online

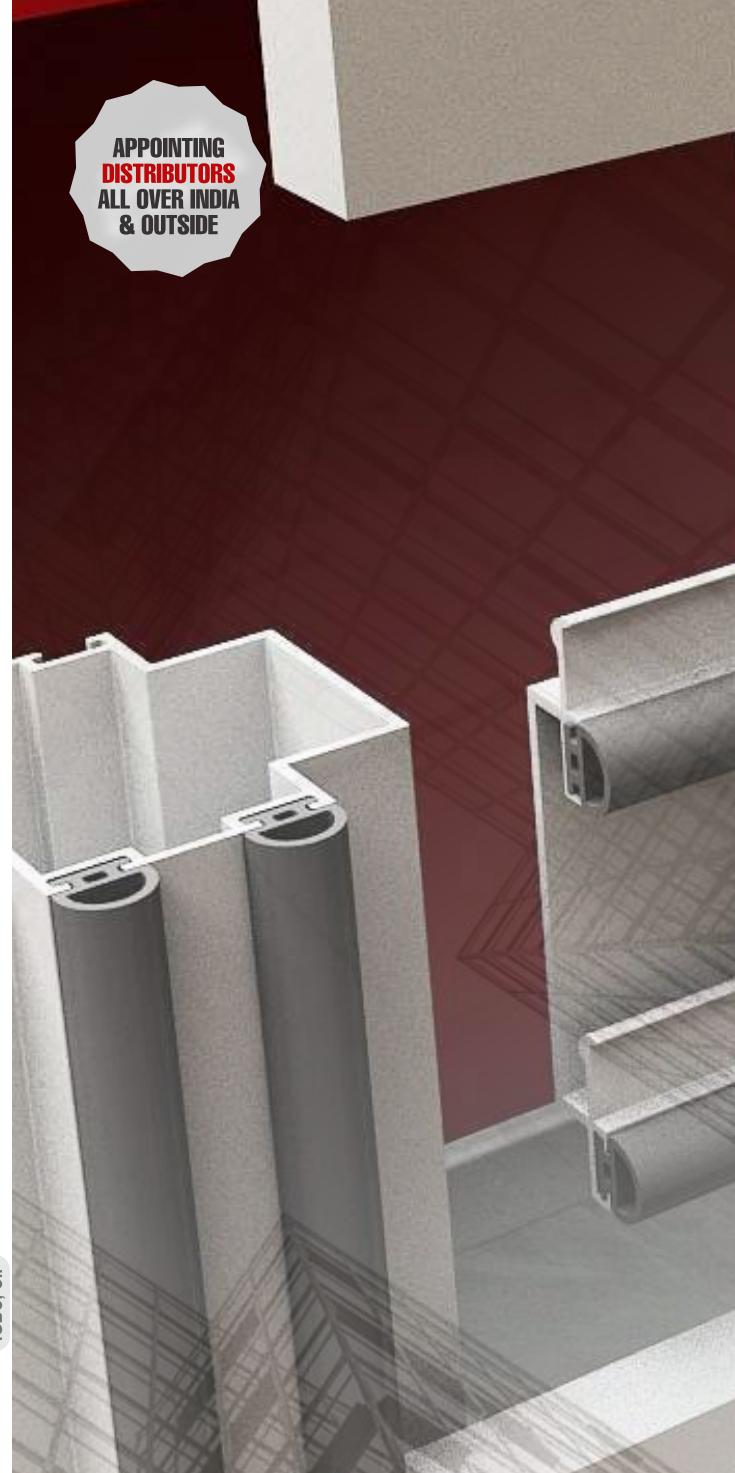

DESIGNERS & MANUFACTURERS  
OF LARGEST NUMBER OF  
GREEN CERTIFIED  
MODULAR FURNITURE &  
INTERIOR SYSTEMS IN INDIA

[www.iqubx.com](http://www.iqubx.com)



*All copyrights, trademarks, Intellectual property rights, patents reserved in name of IQUBX pvt ltd and its directors. Any copying of logo, images, designs, product designs without explicit written permission of the directors of IQUBX pvt ltd shall be a punishable offence. All the product designs are IPR protected*